

LAMELA 2 - PRIZEMLJE - LOKAL 1

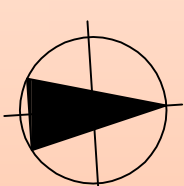

Lamela 2 / PRIZEMLJE / Poslovno

LOKAL 1 (TRGOVINA)				
005	PRODAJNI PROSTOR	48,70/33,93	KERAMIČKE PLOČICE	P ₁
006	TOALETI LOKALA	3,35 / 9,89	KERAMIČKE PLOČICE	P ₁
LOKAL 1 UKUPNO NETO KORISNO 52,05m ²				

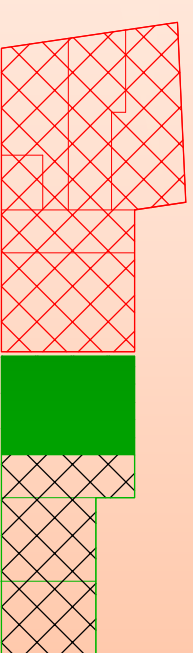
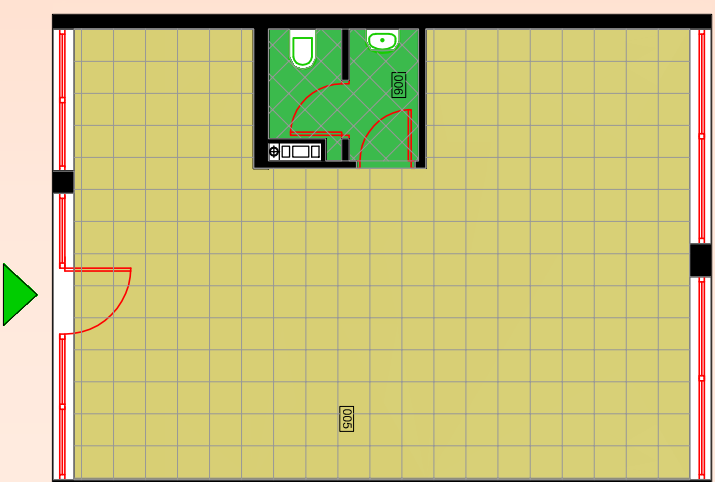

STAMBENO-POSLOVNI OBJEKAT - ULICA MILANA KRANOVIĆA (KOD STUDENTSKOG CENTRA)